

**FOR SALE**  
**+ / - 3,120 SF ON**  
**.25 ACRES**  
**108 W. Division Street**  
**Mt. Juliet, TN 37122**

**Size:**

+/- 3,120 SF on +/- .25 Acres

**Location:** Two miles north of I-40, Exit 226, Adjacent to TN Central RR

**Parcel ID Wilson County**  
 Mt. Juliet 072I C 010.00

**Zoning:** Commercial Town Center

**Year Built:** 1938

**Floor System:** Slab on grade

**Floor Finish:** Concrete

**Exterior Wall:** Concrete block

**Structural Framing:** Masonry

**Roll Up Door:** 10' W x 10.5' H

**Roof:** Metal

**Building shape:** Rectangular design (approx. 40' D x 70' W)

**Spray Booth:** 12' W x 14' H roll up door access

Air Compressor 5 HP included

**Wilson County Taxes:** \$597.18

**Utilities:** Water, sewer, gas are available

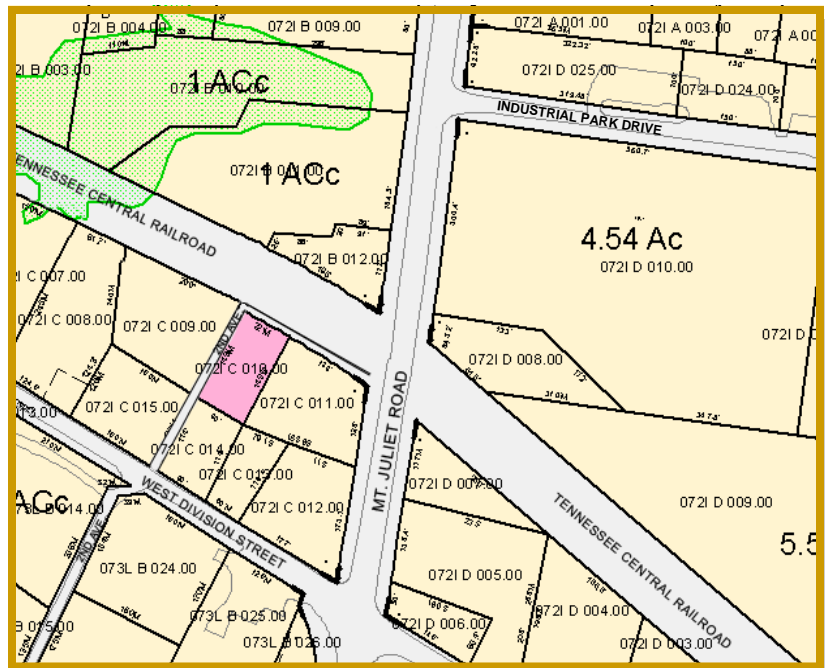
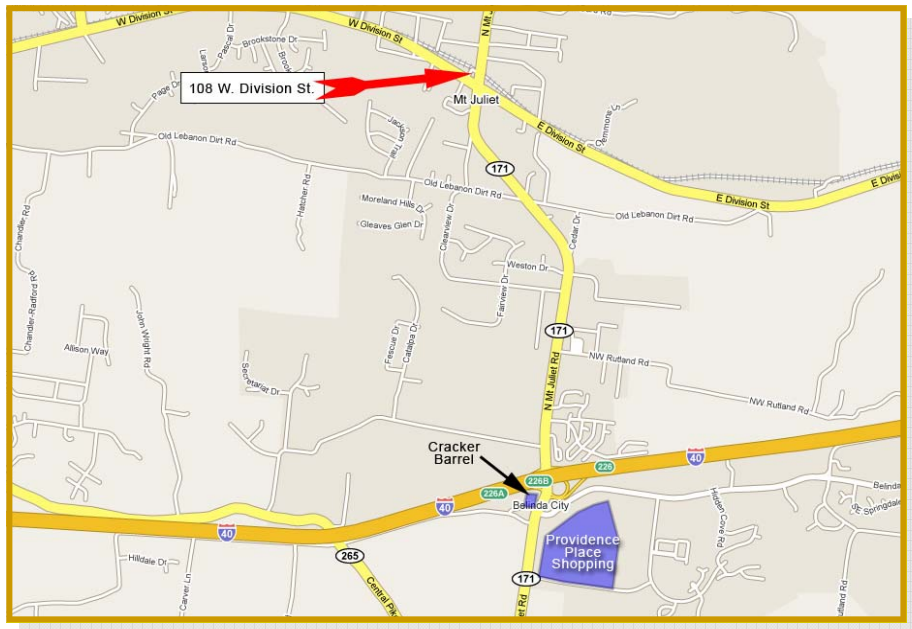

**Exclusively Listed By:**

**Carl Dreifuss**  
**Karr Commercial, LLC**  
**615.804.5893 Mobile**  
**615.321.5555 Office - Ext. 403**  
**cdreifuss@KarrCommercial.com**

Karr Commercial, LLC 5633 Charlotte Avenue, Suite 201 Nashville, Tennessee 37209 615-321-5555 615-352-1414 fax

108 W. Division St.  
Mt. Juliet, TN 37122



Karr Commercial, LLC 5633 Charlotte Avenue, Suite 201 Nashville, Tennessee 37209 615-321-5555 615-352-1414 fax